

BV2C and BV2N-Series - 2 Way, 3-Piece Sanitary Ball Valve

Features

- Live-loaded stem packing
- Precision stainless steel balls reduce torque and friction losses while extending seat life
- Integral ISO 5211 mounting pad
- I.D. polish is 32 Ra maximum
- Lockable handle can prevent accidental actuation
- Standard internal entry blowout-proof stem design
- Full port design matches ball and seat ports to tube I.D. for lower pressure drop and less turbulent flow
- Compact design for areas with tight space restrictions
- Identification tagging available
- Balanced construction minimizes cold flow

Materials

- Product contact material: CF8M stainless steel
- Seats: virgin PTFE, 15% glass reinforced PTFE (RTFE), 25% carbon reinforced PTFE, 50% stainless steel reinforced PTFE, and UHMW

Specifications

- Maximum pressure rating: 1/2" - 2" **1000 PSI WOG**, 2-1/2" - 4" **800 PSI WOG**
- For valve seat options, call Dixon Sanitary at 800.789.1718



1/2" to 2"



2-1/2" to 4"

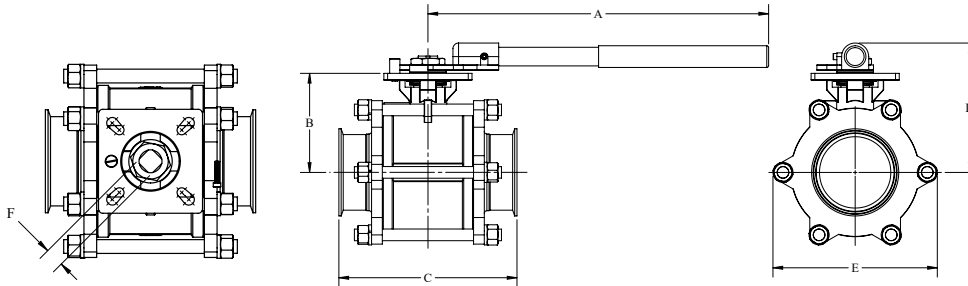

Size	Dimensions					
	A (in)	B (in)	C (in)	D (in)	E (in)	F (mm)
1/2"	4.9	1.5	4.3	3.0	1.9	9
3/4"	4.9	1.8	4.7	3.3	2.2	9
1"	5.6	2.1	4.9	3.6	2.4	11
1-1/2"	9.5	2.7	5.6	4.0	3.1	14
2"	9.5	3.1	6.4	4.8	3.7	14
2-1/2"	18.0	3.8	7.8	5.2	4.8	17
3"	18.0	4.2	9.0	5.7	5.4	17
4"	18.0	5.3	9.5	6.8	8.8	22

Size	Non-Encapsulated				
	316 Stainless Steel Virgin PTFE Part #	316 Stainless Steel RTFE Part #	316 Stainless Steel 25% Carbon PTFE Part #	316 Stainless Steel 50% SS PTFE Part #	316 Stainless Steel with UHMW Part #
1/2"	BV2NV-050CC-A	BV2NG-050CC-A	BV2NC-050CC-A	BV2NS-050CC-A	BV2NU-050CC-A
3/4"	BV2NV-075CC-A	BV2NG-075CC-A	BV2NC-075CC-A	BV2NS-075CC-A	BV2NU-075CC-A
1"	BV2NV-100CC-A	BV2NG-100CC-A	BV2NC-100CC-A	BV2NS-100CC-A	BV2NU-100CC-A
1-1/2"	BV2NV-150CC-A	BV2NG-150CC-A	BV2NC-150CC-A	BV2NS-150CC-A	BV2NU-150CC-A
2"	BV2NV-200CC-A	BV2NG-200CC-A	BV2NC-200CC-A	BV2NS-200CC-A	BV2NU-200CC-A
2-1/2"	BV2NV-250CC-A	BV2NG-250CC-A	BV2NC-250CC-A	BV2NS-250CC-A	BV2NU-250CC-A
3"	BV2NV-300CC-A	BV2NG-300CC-A	BV2NC-300CC-A	BV2NS-300CC-A	BV2NU-300CC-A
4"	BV2NV-400CC-A	BV2NG-400CC-A	BV2NC-400CC-A	BV2NS-400CC-A	BV2NU-400CC-A

Size	Encapsulated				
	316 Stainless Steel Virgin PTFE Part #	316 Stainless Steel RTFE Part #	316 Stainless Steel 25% Carbon PTFE Part #	316 Stainless Steel 50% SS PTFE Part #	316 Stainless Steel with UHMW Part #
1/2"	BV2CV-050CC-A	BV2CG-050CC-A	BV2CC-050CC-A	BV2CS-050CC-A	BV2CU-050CC-A
3/4"	BV2CV-075CC-A	BV2CG-075CC-A	BV2CC-075CC-A	BV2CS-075CC-A	BV2CU-075CC-A
1"	BV2CV-100CC-A	BV2CG-100CC-A	BV2CC-100CC-A	BV2CS-100CC-A	BV2CU-100CC-A
1-1/2"	BV2CV-150CC-A	BV2CG-150CC-A	BV2CC-150CC-A	BV2CS-150CC-A	BV2CU-150CC-A
2"	BV2CV-200CC-A	BV2CG-200CC-A	BV2CC-200CC-A	BV2CS-200CC-A	BV2CU-200CC-A
2-1/2"	BV2CV-250CC-A	BV2CG-250CC-A	BV2CC-250CC-A	BV2CS-250CC-A	BV2CU-250CC-A
3"	BV2CV-300CC-A	BV2CG-300CC-A	BV2CC-300CC-A	BV2CS-300CC-A	BV2CU-300CC-A
4"	BV2CV-400CC-A	BV2CG-400CC-A	BV2CC-400CC-A	BV2CS-400CC-A	BV2CU-400CC-A